



Flat 3, Beach Retreat 11 Ravine Road, Poole BH13 7HS
£290,000 Share of Freehold





THE PERFECT BEACH RETREAT This luxurious ONE BEDROOM apartment has been RECENTLY RENOVATED throughout to an exceptionally HIGH STANDARD. It is a perfect LOCK UP AND LEAVE and also allows PETS and HOLIDAY LETS.

- THE PERFECT BEACH RETREAT
- PRIVATE ENTRANCE
- HOLIDAY LETS PERMITTED
- RECENTLY REFURBISHED THROUGHOUT
- PETS ALLOWED
- CHARACTER PROPERTY

The Property

The perfect beach retreat! This perfectly appointed apartment has been recently refurbished to an exceptionally high standard and offers luxurious accommodation just moments from the sandy beaches and local amenities.

The attention to detail throughout is second to none; the exposed brickwork and contemporary kitchen offers a homely and welcoming feel in the open plan living room.

The bedroom is a generous size with a dressing area to house a wardrobe and an en-suite shower room with a walk in shower.

There is also a separate guest w/c with a utility cupboard housing the washing machine and combi boiler.

Pets allowed and holiday lets allowed.

Perfect for a second home and/or investor seeking an income. Anticipated income of 30/35k pa as a holiday apartment.

Maintenance is £350 per annum along with a ground rent of £200 per annum. Conveyed with the balance of a 999 year lease.

Canford Cliffs

Canford Cliffs village is well known for being one of the most prestigious places to live, it has an assortment of café bars, restaurants and speciality shops with a wide variety of properties ranging from luxury apartments to contemporary designed cliff top residences. The apartment is adjacent to a pathway leading to Flaghead Chine with its sandy beaches. The world famous Sandbanks Peninsula and Poole Harbour are nearby with safe sandy beaches, marinas and yachts clubs as well as a whole host of water sports facilities. The 18 hole Championship Parkstone Golf Club is approximately a mile away whilst the more comprehensive towns of Poole and Bournemouth are approximately two miles equidistant.





GROUND FLOOR
378 sq.ft. (35.1 sq.m.) approx.

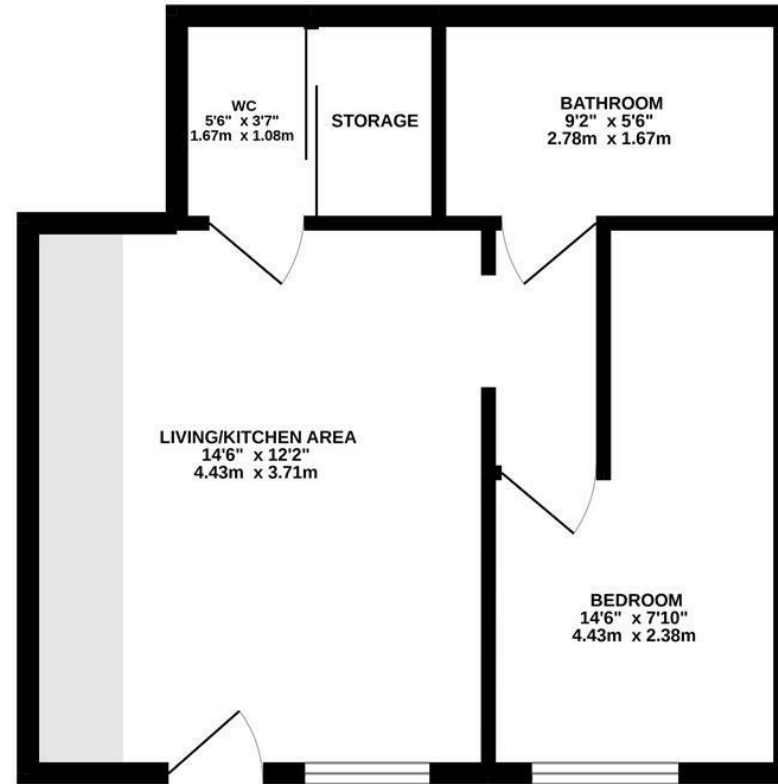

TOTAL FLOOR AREA: 378 sq.ft. (35.1 sq.m.) approx.

Whilst every attempt has been made to ensure the accuracy of the floorplans contained here, measurements of doors, windows, rooms and any other items are approximate and no responsibility is taken for any error, omission or mis-statement. This plan is for illustrative purposes only and should be used as such by any prospective purchaser. The services, systems and appliances shown have not been tested and no guarantee as to their operability or efficiency can be given.
Made with Metropix ©2022

Key Drummond

Tel: 01202 700771
canfordcliffs@keydrummond.com

www.keydrummond.com

All room dimensions given above are approximate measurements

These particulars are intended only to give a brief description of the property as a guide to prospective buyers. Accordingly:

- Their accuracy is not guaranteed and neither Key Drummond Estate Agents, nor the vendors accept any liability in respect of their contents.
- They do not constitute an offer of contract for sale.
- Any prospective purchasers should satisfy themselves by inspection or otherwise as to the correctness of any statements or information in these particulars. Please refer to the Agents if you require further clarification or information.

The Agent has not tested any apparatus, equipment, fixtures and fittings or services and so cannot verify that they are in working order or fit for the purpose. A buyer is advised to obtain verification from their Solicitor or Surveyor.

References to the Tenure of a Property are based on information supplied by the Seller. The Agent has not had sight of the title documents. A Buyer is advised to obtain verification from their Solicitor.

